

LOUISA RYLAND HOUSE

Operated by RE-DEFINED.

REDEFINED

A MAPP company

LOUISA RYLAND HOUSE

44 NEWHALL ST, COLMORE BUSINESS DISTRICT, BIRMINGHAM, B3 3PL

AT A GLANCE

Louisa Ryland House provides refined workspace for the people defining Birmingham's future.

- Offices for teams of 16 - 120
- Vast amounts of communal space, event space along with an onsite barista
- Bookable meeting rooms and event space

PRIME LOCATION

Located squarely in Birmingham's Colmore Business District, Louisa Ryland House is a stone's throw away from both local and national transport.



Birmingham New Street



Birmingham Snow Hill

ADDED EXTRAS

LRH features an on-site community team, cafe and barista, and a plethora of event spaces for every occasion.

Committed to sustainability, we collaborate with climate conscious suppliers, and showcase local talent through exhibitions from Birmingham School of Art.

RE-DEFINED SPACES

A RE-DEFINED building takes itself seriously.

We pride ourselves on high-quality finishes, sustainable materials, a no-expense-spared approach to technology, infrastructure and connectivity, simplified financial management and - above all - a best-in-class Operations approach.

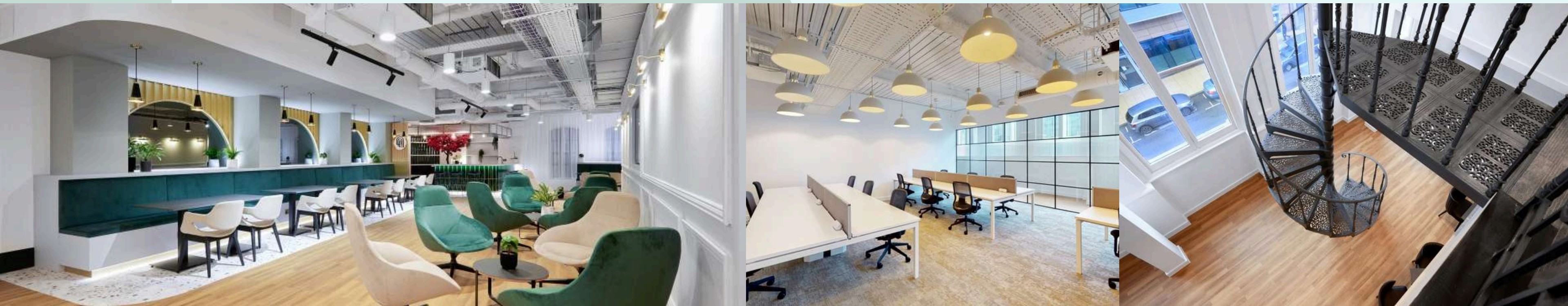

WORKING AT LOUISA RYLAND HOUSE

SPACES AT LRH

A double height marble tiled reception leads to our communal spaces and office suites alike, and is an impressive entryway for guests.

Our workspaces blend historic charm with contemporary amenities, from the individual climate control, to the high speed internet and spacious desks.

In the shared spaces, relax in velvet banquettes surrounded by Crittal-inspired partitions and bottle green tiles.

We redefine the workspace as you know it; delivering unparalleled working environments in beautifully designed, sustainable spaces.

As a MAPP company, we benefit from 25 years of experience and scale.

As a leader in sustainability, we are proud to be a certified B Corp – the first and only major UK real estate consultancy to achieve that.

AVAILABILITY

At Louisa Ryland House we have large, enterprise-ready office suites available from 24 - 120 desks.

The Suites have been recently refurbished to the highest standard, and are move-in ready.

All have their own dedicated meeting rooms, unit-level climate control, business-grade Wi-Fi and access to our full roster of House facilities.

STREAMLINED FINANCES

Terms starting from 12 months.
Inclusive rent including:

- Rent
- Service charges and insurance
- Business Rates
- Utilities
- Consumables including weekly stocking of tea, coffee, fruit, milk
- Wireless connectivity, IT & data, security & access control
- Cleaning
- Facilities management - i.e. maintenance, repairs and health & safety
- Furniture
- 24h access
- Secure bicycle storage
- Shower facilities
- Cafe, lounge, and events areas
- Multi-faith Room

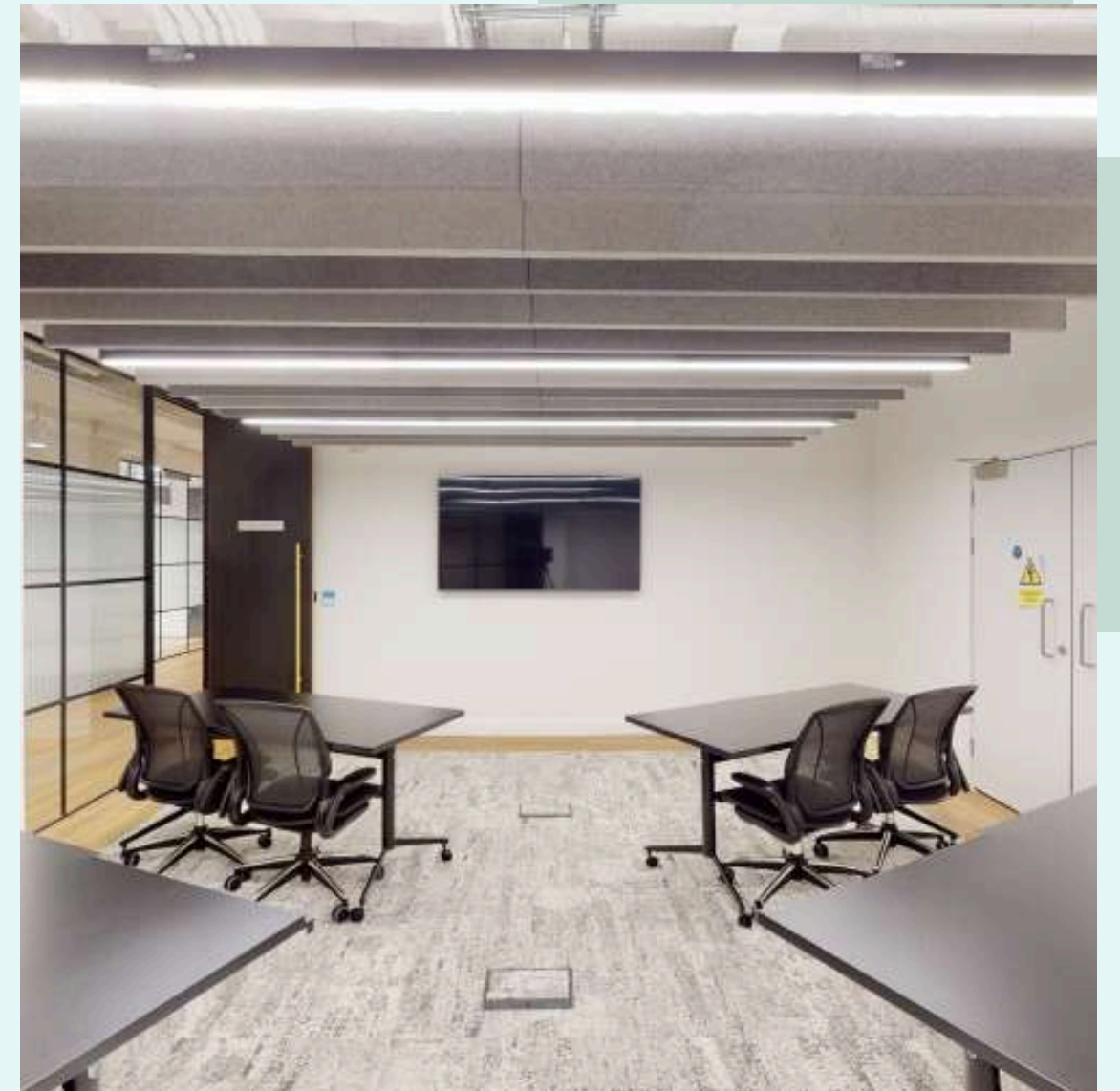

FLOORPLANS

LOWER GROUND

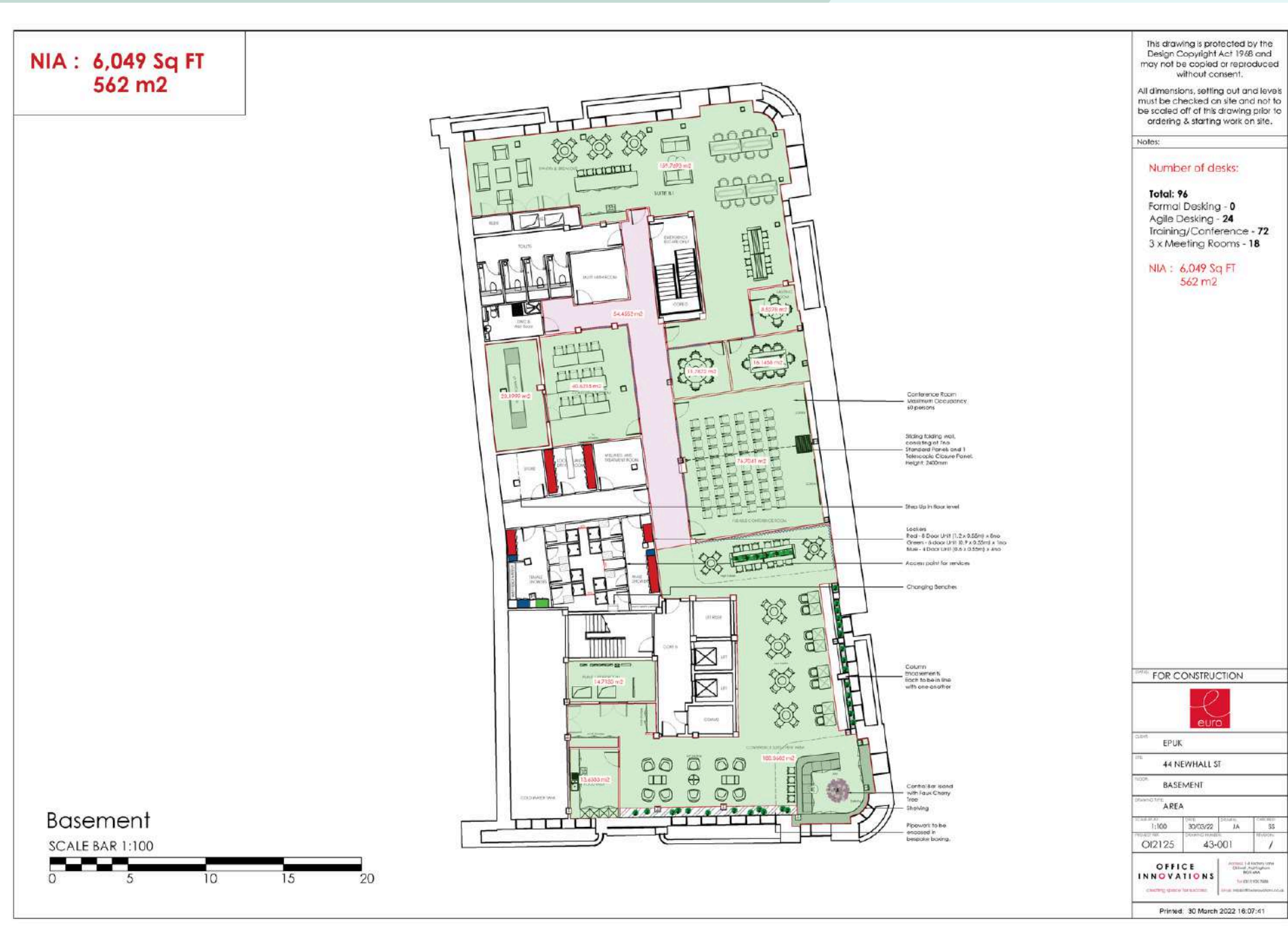

FLOORPLANS

GROUND FLOOR

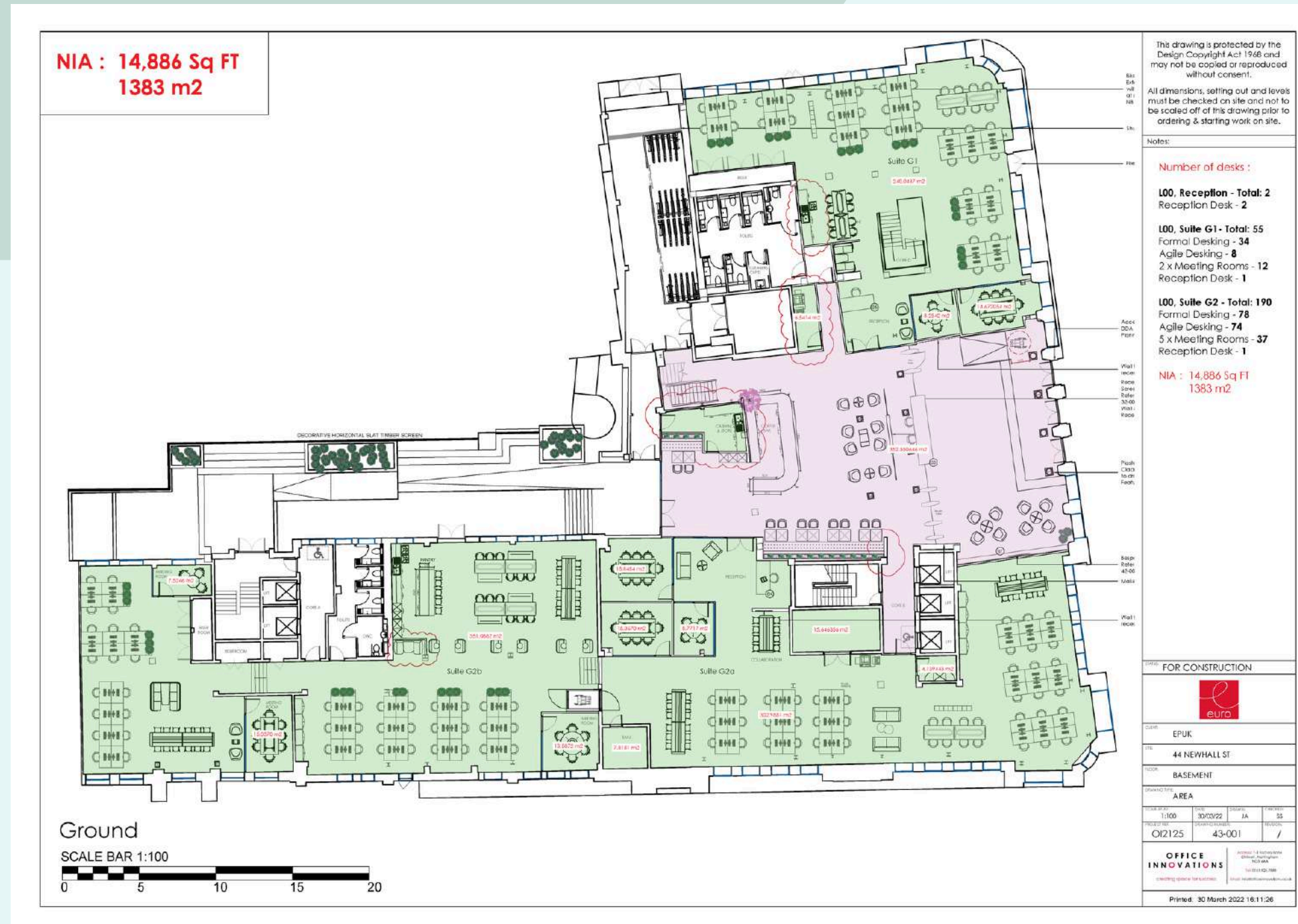

FLOORPLANS

SECOND FLOOR

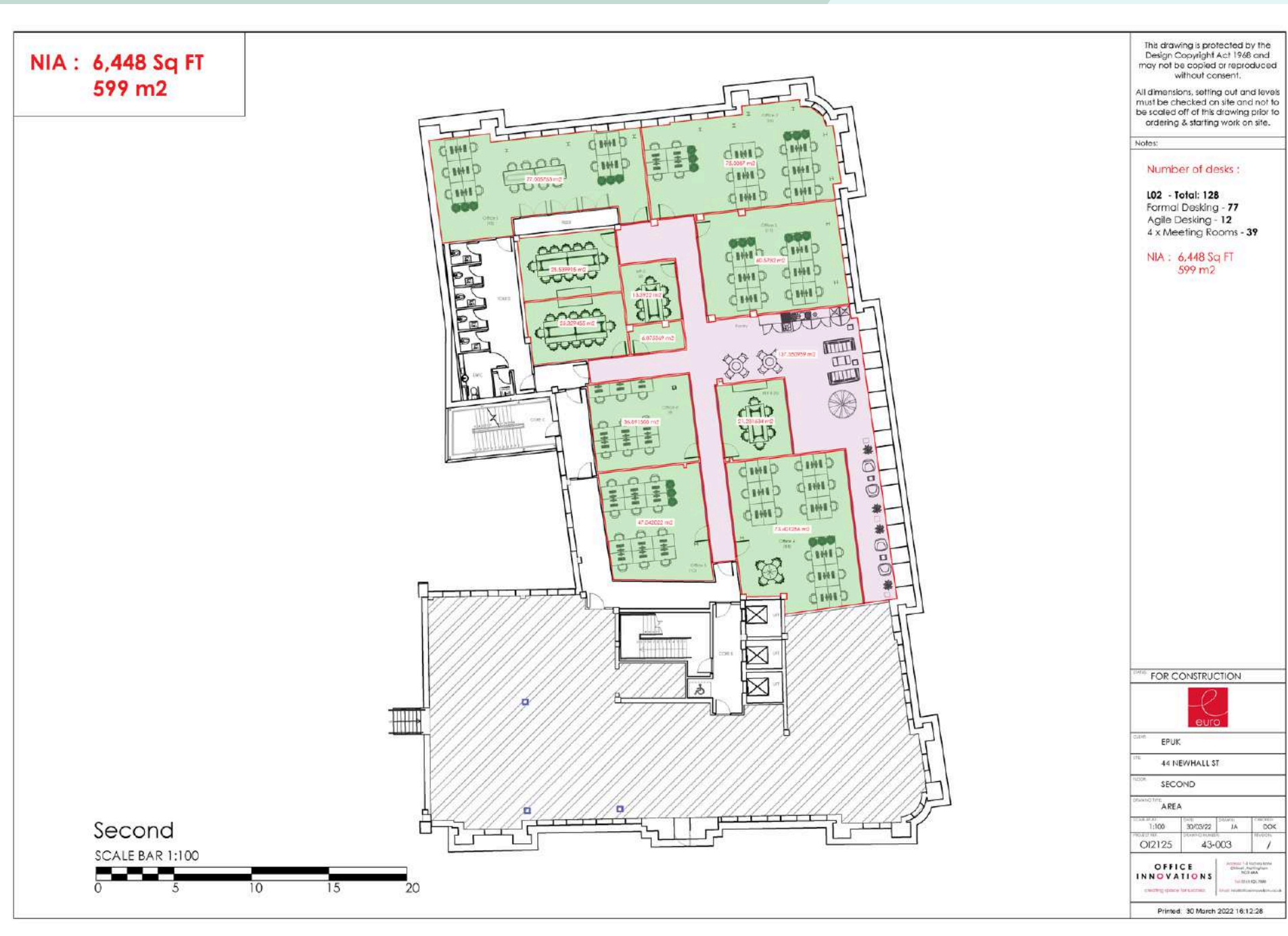

FLOORPLANS

THIRD FLOOR



CONTACT

For more information on Louisa Ryland House, please get in touch.

Ainsley Sutherland
Sales & Leasing Manager

ainsley@re-defined.co.uk

020 7908 5597

07977 760894



FLEX BY MAPP LLP trading as RE-DEFINED LLP
April 2024

